

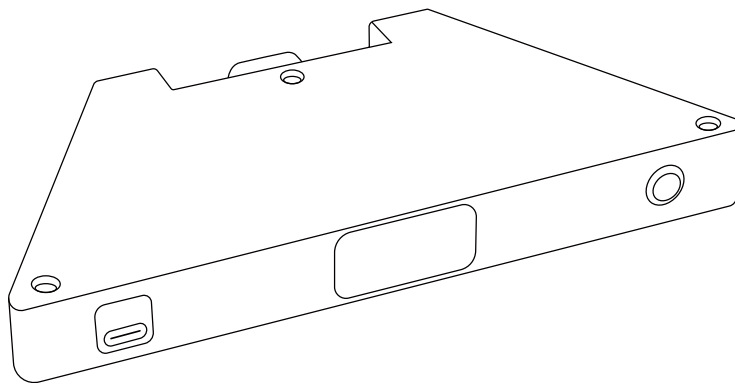

# LinkPower 1

Power Bank for Starlink® Mini



Quick Start

V 1.2

# Introduction

Meet the LinkPower 1 power solution!

The LinkPower 1 power bank is a compact, high-efficiency power solution designed exclusively for the Starlink® Mini.

With a 99Wh battery capacity, LinkPower 1 provides over 4 hours of continuous runtime, keeping your internet connection alive - even in remote locations.

LinkPower 1 supports USB-C bidirectional power delivery. The USB-C port can deliver 65W<sup>1,2</sup> output, perfect for powering your phone, laptop, and other USB-C devices.

Best of all, LinkPower 1 can power the Starlink® Mini while charging itself via the USB-C port - ensuring uninterrupted operation when you need it most.

With a simple long press of the power button, you can turn the DC output on or off to control the Starlink® Mini.

**NOTE:** Before using LinkPower 1 for the first time, you must activate it. Please refer to the "[Setup](#)" section for activation methods.

**1.** Input (Charging) and Output (Discharging) Power Limit can be set via Web App. The max power limit is 140W.

**2. Warning:** Charging or discharging the battery at high power levels may significantly reduce its lifespan. For optimal battery health, avoid excessive power usage unless necessary.

## What's In the Box

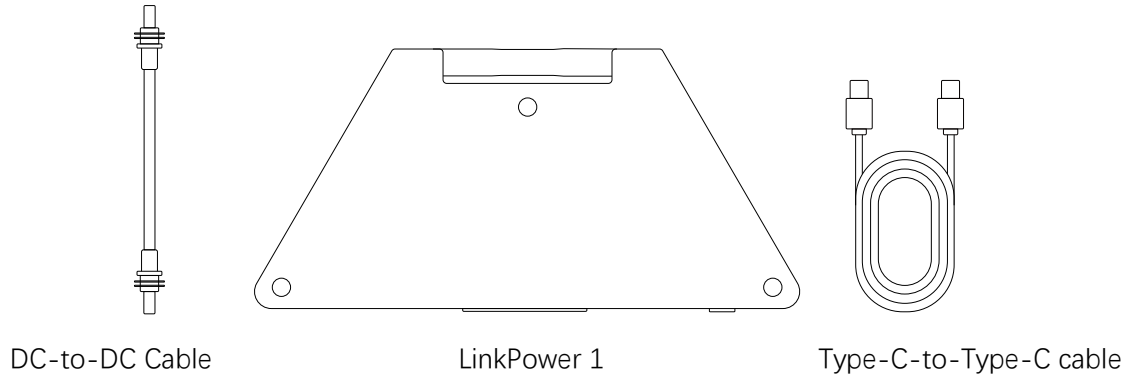

## Device Overview

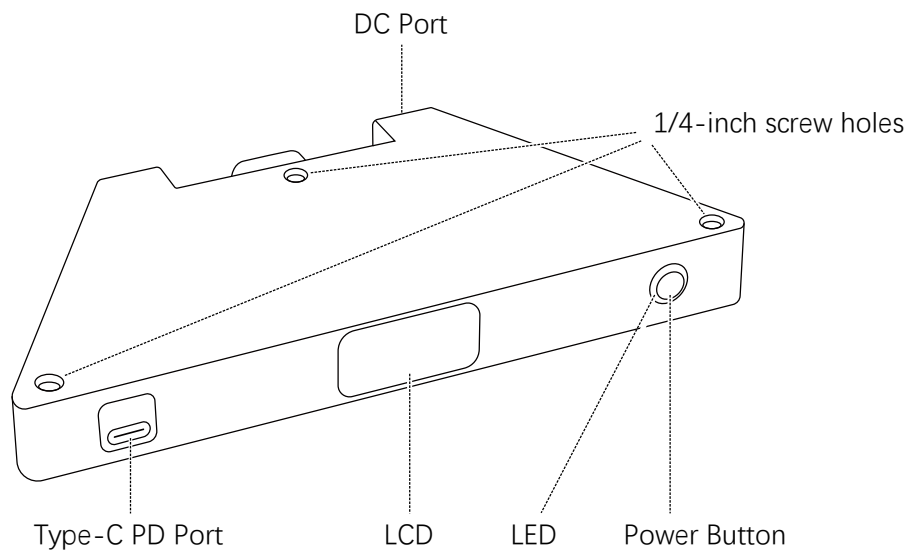

### Setup

1. Place the Starlink® Mini face down on a table or other flat surface. Be careful not to scratch the face of the Starlink® Mini. Remove the kickstand if used.
2. Unpack the LinkPower 1 and plug the included DC-to-DC cable into the DC port on the LinkPower 1.

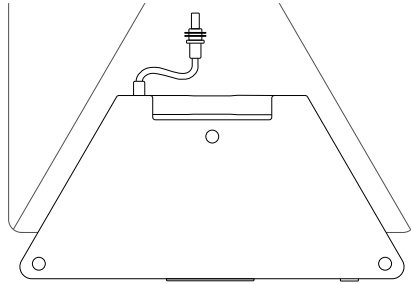

3. Plug the other end of the DC cable into the DC port on the Starlink® Mini. Ensure the plug is fully inserted such that the plug face is flush with the DC port surface to guarantee a secure connection.

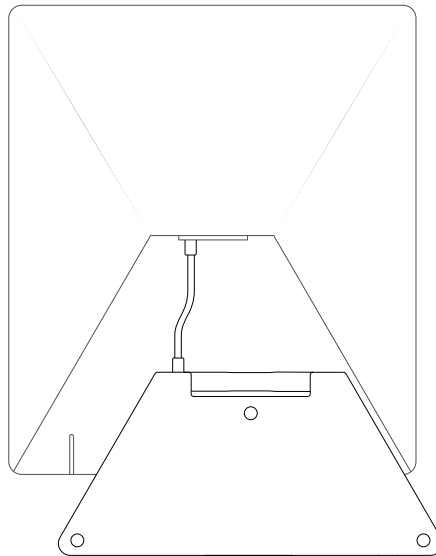

## LinkPower 1 Quick Start

---

4. Plug in an external PD power supply to **activate** the LinkPower 1. When the LinkPower 1 is powered on, the LED indicator on the power button will light up. The Starlink® Mini will automatically power on, and its LED indicator will begin flashing.

**NOTE:** After LinkPower 1 has been activated, you can remove the external PD power supply.

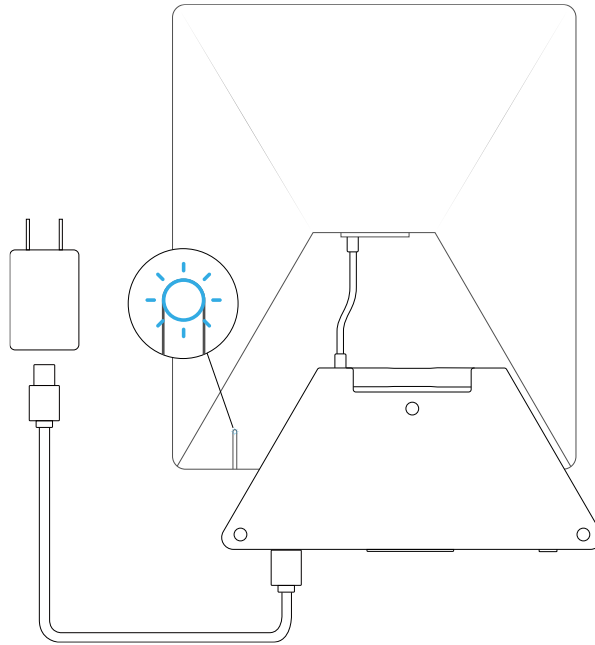

5. Gently slide the LinkPower 1 toward the Starlink® Mini until you hear a clicking sound. This indicates that the LinkPower 1 is securely attached to the Starlink® Mini.

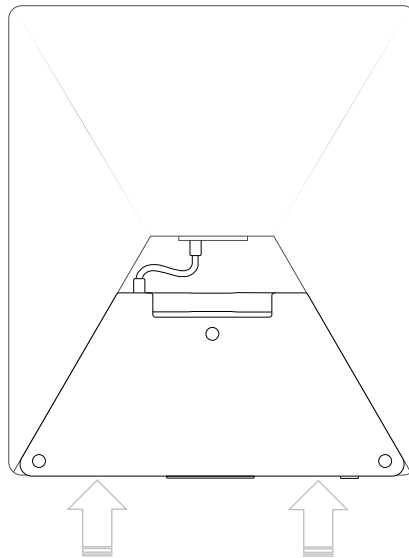

6. Setup is complete. You can now use your Starlink® Mini as normal, powered by the attached LinkPower 1.

### Usage

### Charging

To charge LinkPower 1 and simultaneously power the Starlink® Mini, connect an external USB Type-C PD power supply to LinkPower 1.

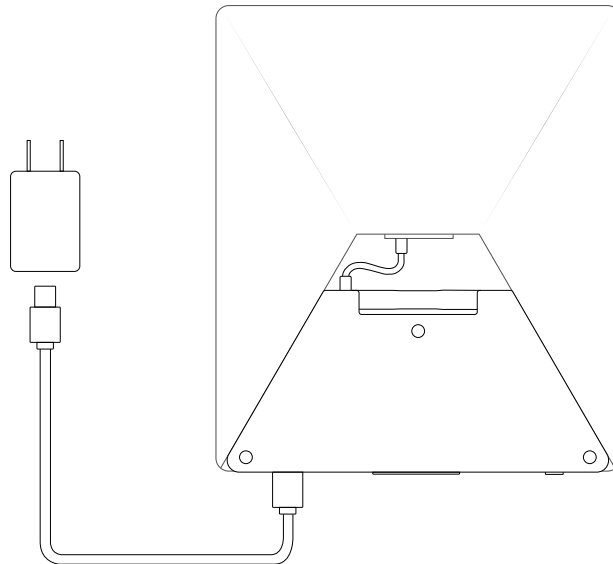

### Works as a normal power bank

When needed, LinkPower 1 can also be used to charge other devices through its USB Type-C PD port.

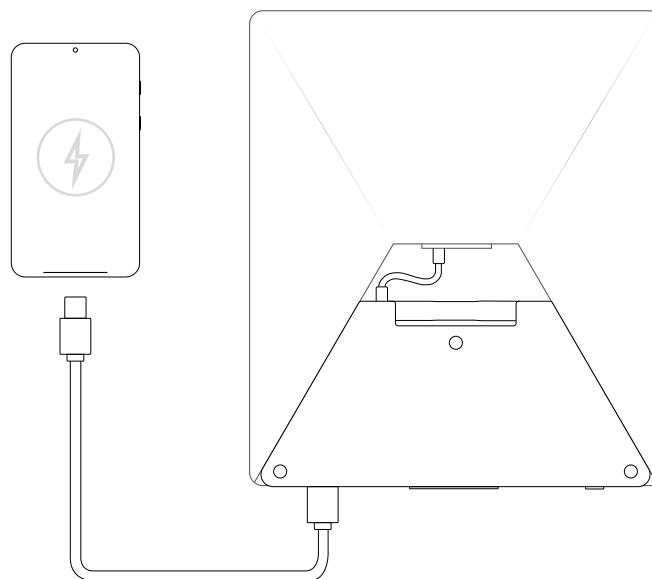

# LinkPower 1 Quick Start

## Check the status

To check the status of LinkPower 1, press Power Button once to turn on the LCD screen.

Following is the layout of the full UI:

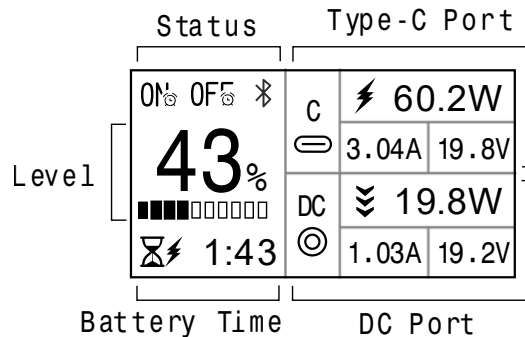

<b>Level</b>	Displays Battery Level
<b>Battery Time</b>	Displays the estimated time until LinkPower 1 is fully charged. Displays the estimated time until LinkPower 1 is fully discharged.
<b>Status</b>	Indicate a timer is active for turning on the DC port Indicate a timer is active for turning off the DC port Indicate work status of Bluetooth
<b>DC Port</b>	Displays the power, current, voltage and work status of the DC port Indicate DC port is discharging
<b>Type-C Port</b>	Displays the power, current, voltage and work status of the Type-C port Indicate Type-C port is charging Indicate Type-C port is discharging

When the DC port is enabled, the LED indicator will gently pulse.

## Manually Controlling the DC Port

You can manually enable or disable the LinkPower 1's DC port, which in turn powers your Starlink® Mini on or off.

To do this, press and hold the Power Button for at least 2 seconds. The LED indicator will quickly flash twice to confirm this action.

- When the DC port is enabled, the LED indicator will gently pulse.
- When the DC port is disabled, the LED indicator will turn off.

### Shutting Down LinkPower 1

If you don't plan to use LinkPower 1 for an extended period, you can shut it down completely. This helps to preserve battery life and health.

To do so, press and hold the Power Button for at least 10 seconds. Once LinkPower 1 is fully shut down, the Power Button will become unresponsive.

To restart LinkPower 1 from a complete shutdown, simply plug in an external power supply.

### Using Web App

**NOTE:** The Web App currently only works on following browsers:

- Desktop: Chrome, Edge, Opera
- Android: Chrome, Edge, Opera, Samsung Internet

**NOTE:** The Web App can function offline after your initial visit.

Scan the following QR code, or the one on the back of the LinkPower 1



Or type in the URL <https://peakdo.com/pwa/link-power-1/index.html> manually.

### (Optional) Install Web App

**NOTE:** You may need to grant your browser 'Home screen shortcuts' permission.

You can access the Web App directly in your browser. For a more integrated experience, you can also install it like a native app, which provides a launch icon on your desktop or allows it to be pinned to your Windows Taskbar.

# LinkPower 1 Quick Start

---

When you visit the Web App for the first time, your browser may prompt you to install it.

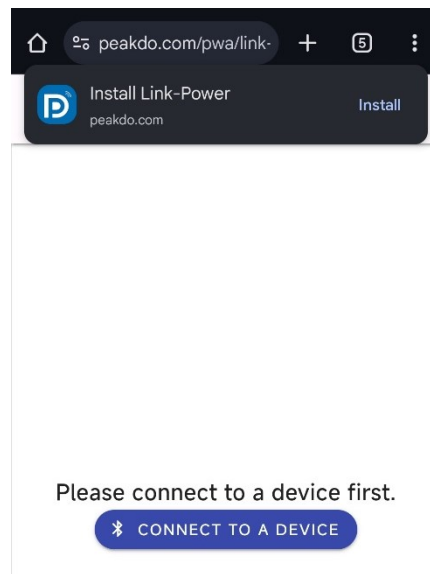

If not, you can typically find the installation option via your browser's "Add to Home screen" or similar menu.

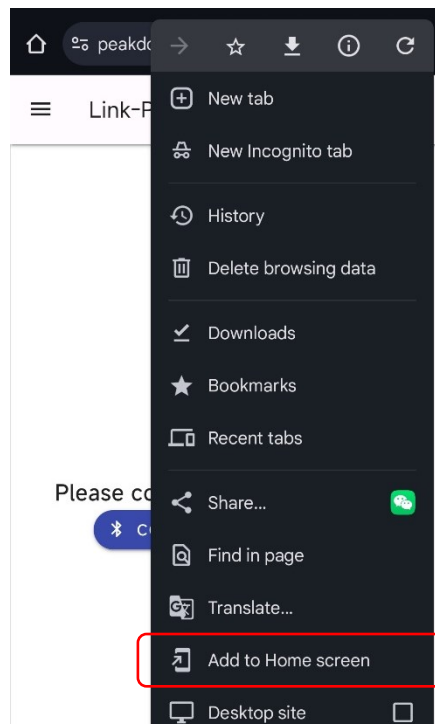

# LinkPower 1 Quick Start

Follow the on-screen guide to install the Web App:

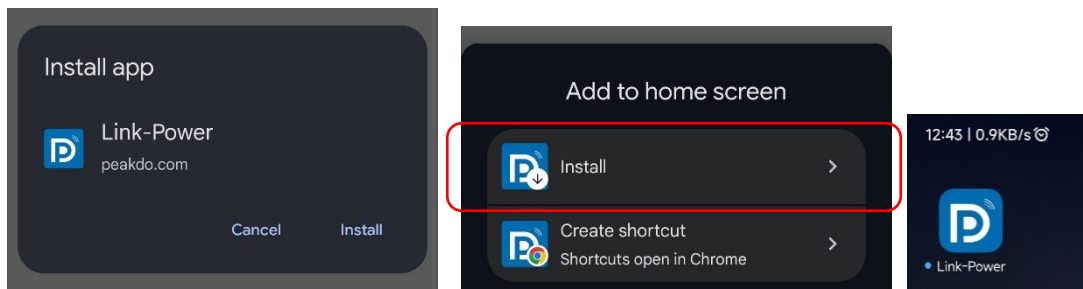

## Connect to LinkPower 1

The Web App communicates with LinkPower 1 via Bluetooth.

You can connect to your LinkPower 1 by tap the “Connect to a device” button.

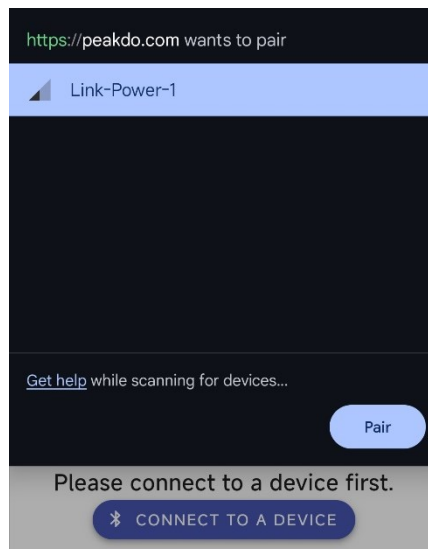

Your browser will scan for all nearby LinkPower 1 devices and display them in a list, allowing you to select one to pair.

**NOTE:** In some situations, a previously paired or bonded device may not show up in the list. You can unpair or remove the bond from your system and try again.

# LinkPower 1 Quick Start

## Grant permission to Browser

If your browser lacks Bluetooth access permission, it may prompt you to grant it.

Follow the on-screen guide to allow access:

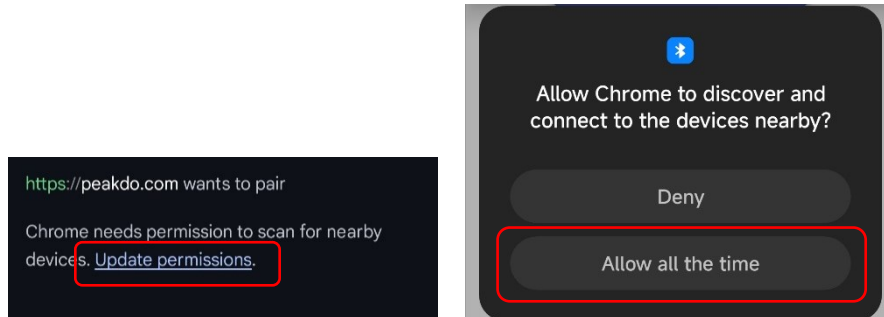

## The UI

Following is the UI of the Web App, it's pretty straightforward.

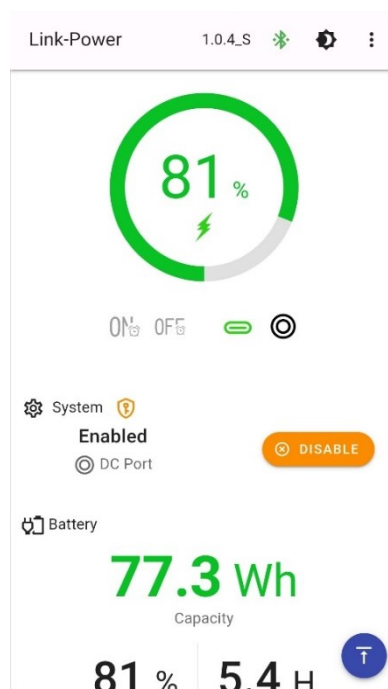

Some advance actions hidden by default. You can show them by check the “Expert Mode” menu in the three dots menu:



### Pair with LinkPower 1

Some actions are marked with the  icon because they require authentication. These are often advanced or sensitive actions.

When you perform one of these actions, your operating system (OS) will prompt you to enter a PIN to pair with the LinkPower 1 device. You'll only need to do this once, unless you delete the LinkPower 1 bond from your OS settings.

**NOTE:** The default PIN is "020555".

## Specifications

Product Name	LinkPower 1
Battery Capacity	99Wh, 27500mAh(3.6v)
Battery Runtime	~4Hours for Starlink® Mini
Battery Type	21700 Lithium Battery
Ports	PD/USB-C; DC 5.5 x 2.1
DC Output	DC 15-21V. 65W Max.
PD/USB-C Input	5V-3A; 9V-3A; 12V-3A; 15V-5A; 20V-5A; 28V-5A. Default 65W Max <sup>1,2</sup> .
PD/USB-C Output	5V-3A; 9V-3A; 12V-3A; 15V-5A; 20V-5A; 28V-5A. Default 65W Max <sup>1,2</sup> .
Screen	1.47" LCD
Control	Power Button / Bluetooth Low Energy
Others	LED Indicator; Three standard 1/4-inch screw holes.
Dimensions	243mm x 115mm x 27 mm
Weight	~645g
Working Temperature	-20°C ~ 60°C
Waterproof Rating	IPX4

**1.** Input (Charging) and Output (Discharging) Power Limit can be set via Web App. The max power limit is 140W.

**2. Warning:** Charging or discharging the battery at high power levels may significantly reduce its lifespan. For optimal battery health, avoid excessive power usage unless necessary.