

Golf Cart 36/48 Volt Albright Solenoid Installation Instruction

We are striving to build an reliable brand of golf carts parts and accessories.

Hope this manual can assist you to easier install.

For more technical support, please reach us via

Website : www.10101.com

Email : sale_service@10101.com

Facebook : zhong zaiyang

Youtube : 10L0L



Scan To Get
Installation Video

Contents	Qty	Installation Tools	Qty
Solenoid.....	1	3/8-inch (10mm) socket.....	1
(See figure 1)		1/2-inch (13mm) spanner.....	1
		9/16-inch (14mm) spanner.....	1

Assembly diagram

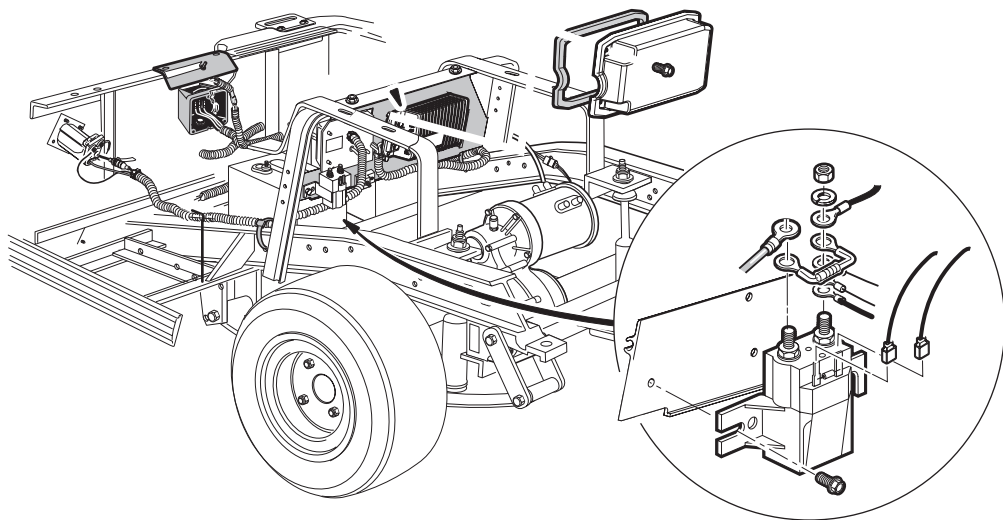

Installation Tools



3/8 inch (10mm)



1/2 inch (13mm)



9/16 inch (14mm)

Installation Steps

1. Park the vehicle on level ground.
2. Turn the key to "OFF" position and remove it from the switch.
3. Make sure the parking brake is set.
4. Remove the screws of battery negative cables with the 9/16-inch (14mm) spanner, then remove the negative cables.

(See figure 2)

5. Remove 2 screws beside the solenoid with the 1/2-inch (13mm) spanner, then remove the cables.

(See figure 3)

1



2



3

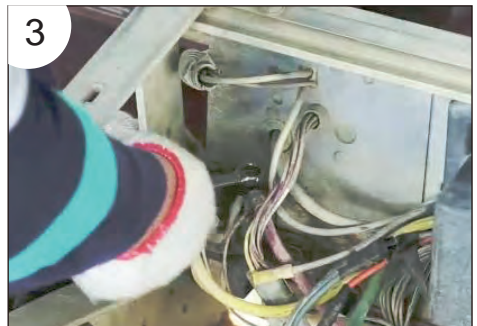

6. Loosen 2 screws on the component mounting plate with the 3/8-inch (10mm) socket.

(See figure 4)

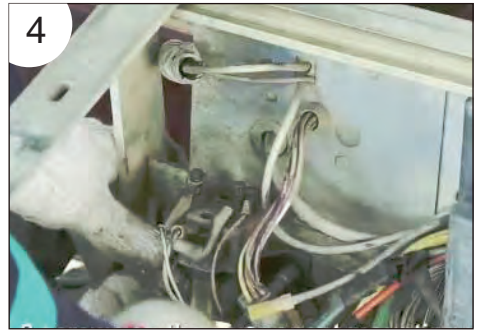

7. Disconnect the 2 wires.

(See figure 5)



8. Remove the solenoid.

(See figure 6)

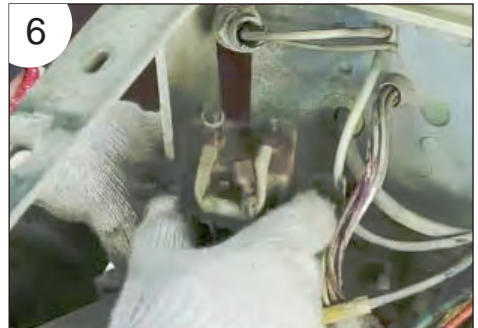

9. Remove the resistor assembly.

(See figure 7)



10. Install the new resistor assembly.

(See figure 8)



11. Install the new solenoid.

(See figure 9)

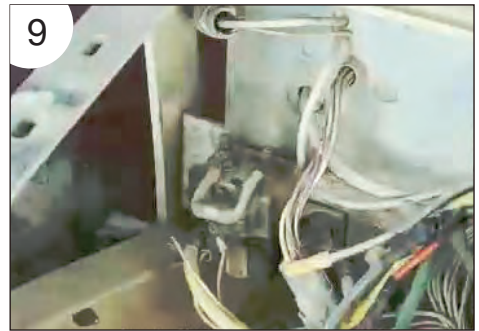

12. Tighten 2 screws beside the solenoid with the 3/8-inch (10mm) socket.

(See figure 10)

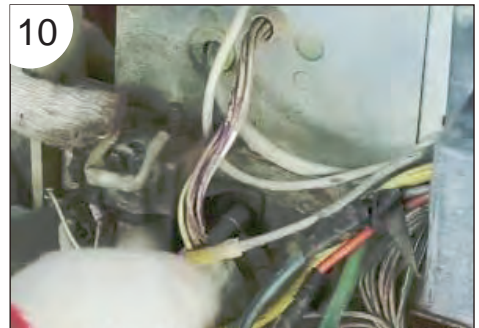

13. Connect the wires (The yellow wire is on the left; Two red wires are on the right).

(See figure 11)



14. Connect the wires of solenoid.(The blue and white wire is on the left. The red wire is on the right.)

(See figure 12)

This all completes your installation.

