



Club Car DS Accelerator Pivot Rod Asm Kit Installation Instruction

We are striving to build an reliable brand of golf carts parts and accessories.

Hope this manual can assist you to easier install.

For more technical support, please reach us via

Website : www.10LOL.com

Email : sale_service@10LOL.com

Facebook : [zhong zaiyang](#)

Youtube : 10LOL



Scan To Get
Installation Video

Contents	Qty	Installation Tools	Qty
Accelerator Pivot Rod Qty.....	1	5/16-inch (8mm) socket.....	1
Spacer.....	1	7/16-inch (11mm) spanner.....	2
(See figure 1)		9/16-inch (14mm) spanner.....	2

Assembly Diagram

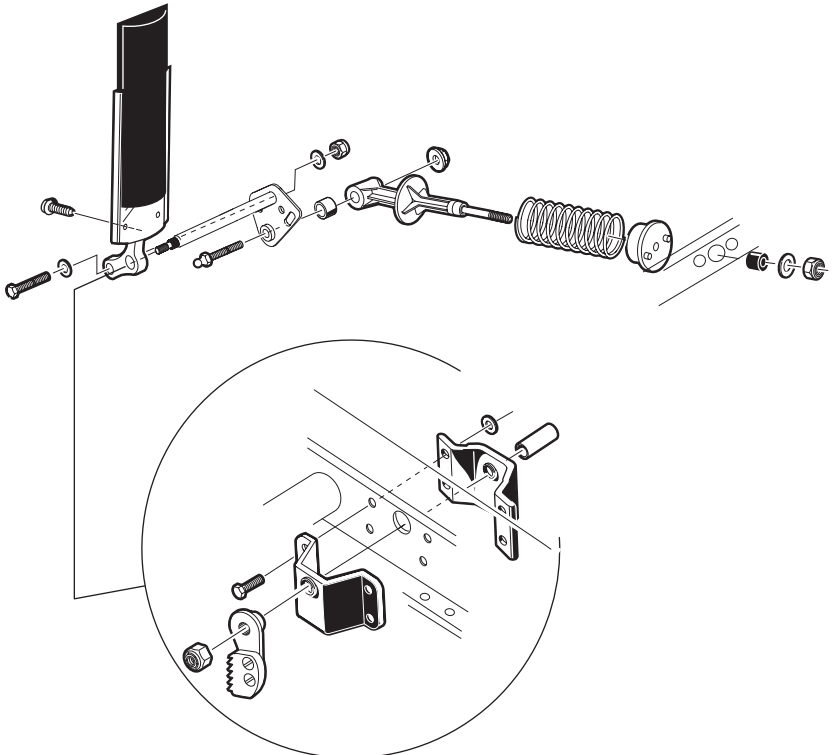

Installation Tools



Installation Steps

1. Park the vehicle on level ground.
2. Turn the key to "OFF" position and remove it from the switch.
3. Make sure the parking brake is set.
4. Remove the screws of the park brake ratchet with a 9/16-inch (14mm) spanner.

(See figure 2)

5. Remove 2 screws of the motor controller output regulator with a 5/16-inch (8mm) socket.

(See figure 3)



6. Remove the motor controller output regulator.

(See figure 4)

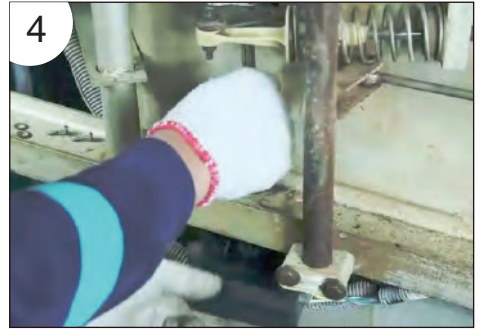

7. Remove the drive bar.

(See figure 5)

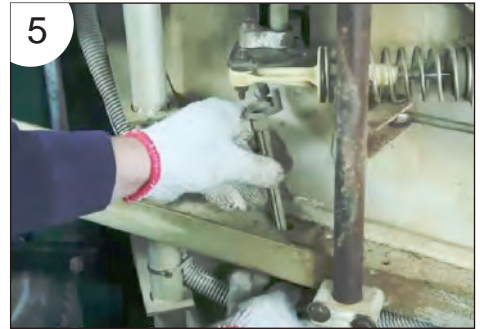

8. Remove 2 screws of the brake return spring with two 7/16-inch (11mm) spanners.

(See figure 6)

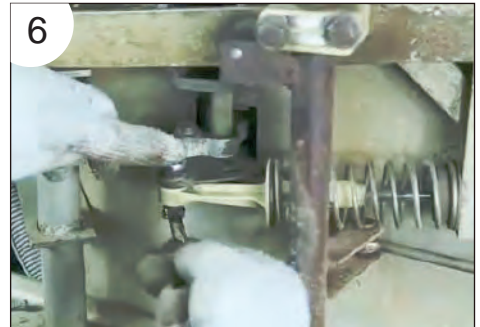

9. Remove the screws of the accelerator pivot rod with two 9/16-inch (14mm) spanners.

(See figure 7)



10. Remove the park brake ratchet.

(See figure 8)

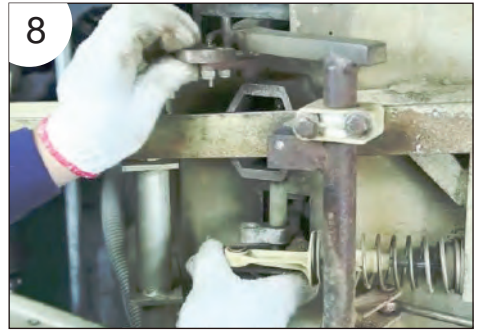

11. Remove the accelerator pivot rod.

(See figure 9)

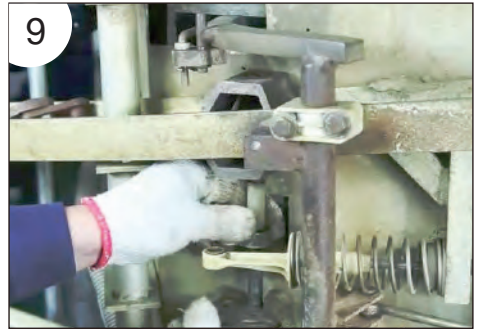

12. Install the accelerator pivot rod(Do not leave the spacer.)

(See figure 10)



13. Install the park brake ratchet.

(See figure 11)



14. Tighten the screws of the park brake ratchet with a 9/16-inch (14mm) spanner.

(See figure 12)



15. Install the brake return spring and tighten the screws with two 7/16-inch (11mm) spanners.

(See figure 13)

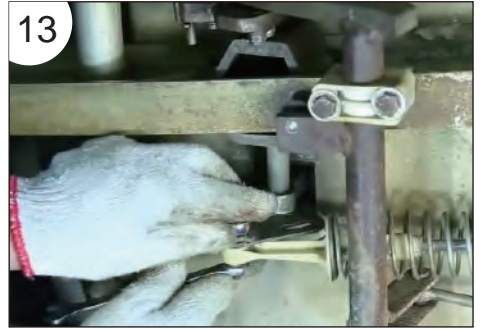

16. Install the drive bar.

(See figure 14)



17. Install the motor controller output regulator and tighten the screws with a 5/16-inch (8mm) socket.

(See figure 15)



This all completes your installation.