



# MCOR Motor Controller Input Installation Instruction

We are striving to build an reliable brand of golf carts parts and accessories.

Hope this manual can assist you to easier install.

For more technical support, please reach us via

Website : [www.10101.com](http://www.10101.com)

Email : [sale\\_service@10101.com](mailto:sale_service@10101.com)

Facebook : zhong zaiyang

Youtube : 10L0L



Scan To Get  
Installation Video

## Contents

MCOR Motor Controller Input.....1

( See figure 1 )

## Qty

## Installation Tools

Slotted screwdriver.....1

## Qty

## Assembly Diagram

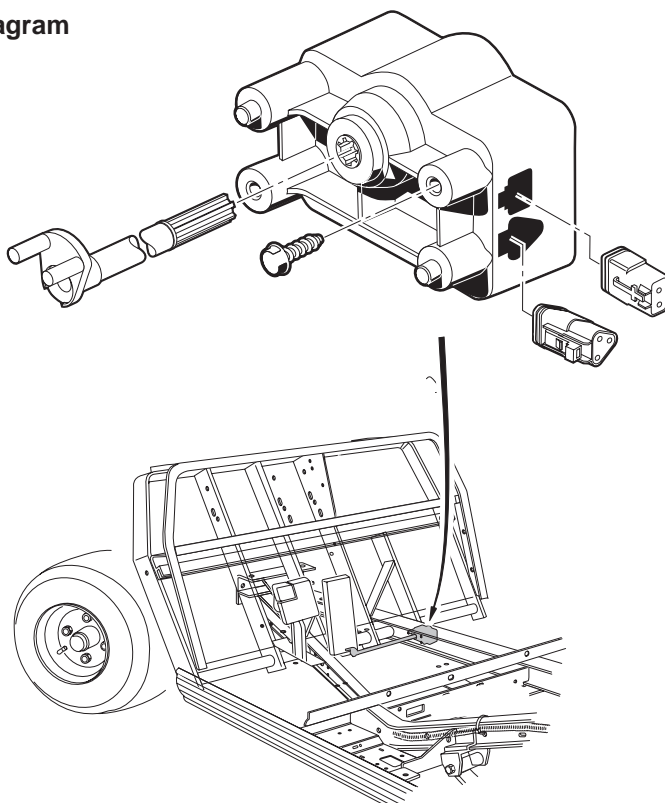

## Installation Steps

1. Park the vehicle on level ground.
2. Turn the key to “OFF” position and remove it from the switch.
3. Make sure the parking brake is set.
4. Remove 2 screws of the MCOR Motor Controller Input with the slotted screwdriver.  
  
(See figure 2)
5. Remove the MCOR drive bar.  
  
(See figure 3)

### Installation Tools



Slotted Screwdriver

1



2

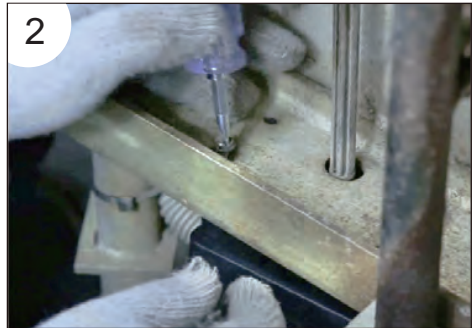

3



6. Disconnect harness of the MCOR Motor Controller Input.

(See figure 4)



7. Remove the MCOR Motor Controller Input.

( See figure 5)



8. Install the new MCOR Motor Controller Input.

( See figure 6)



9. Install the MCOR drive bar.

( See figure 7)



10. Connect the harness.

( See figure 8)



11. Install the screws of the MCOR Motor Controller Input and tighten them with the the slotted screwdriver.

(See figure 9)



This all completes your installation.